

SCHOK classic

Quick user manual

SCHOK classic

STEP ONE - GET TO KNOW YOUR SCHOK CLASSIC



STEP TWO - HOW TO CHARGE YOUR SCHOK CLASSIC

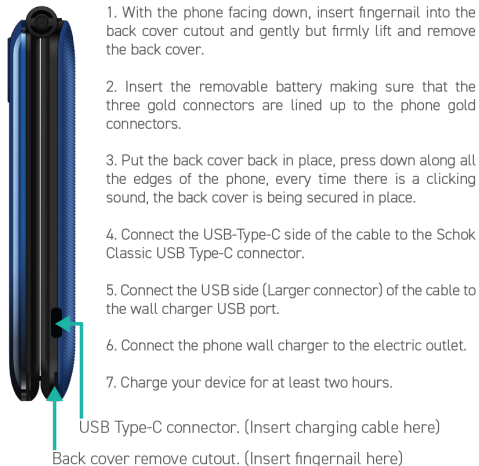

TIP: Although your phone arrives pre-charged, a good practice dictates that prior to the first time of operation, let the battery charge for at least two full hours.

WARNING! Use only approved chargers. Incompatible chargers could damage your phone and void the warranty. Never leave the phone charging for more than eight hours.

Warranty: All Schok products are manufactured with the best quality standards to offer years of trouble-free operation. In the event that this unit is not working correctly or it is defective in workmanship or materials we will repair or replace it (at our option) free of charge for 12 months from the date of purchase. For easier and faster warranty service, please call our toll-free number 1-888-48-SCHOK, a customer service representative will explain in detail the steps to follow. If the product is still in warranty Schok will be happy to repair or replace your unit free of charge. If the owner wants to return the defective product to the store, this needs to be done within the first 15 days of the date of purchase, presenting the original receipt and the product in its original box and with all its accessories. Before you call our help desk please read in detail the warranty policy that came in this product and fill the small questionnaire in the space "TO FILL", be prepared to write down the RMA number that our customer service representative is going to give you. If the product has been damaged by an accident or failure to follow this instruction manual, acts of God, has been tampered, misused or fixed by any unauthorized personnel, this warranty policy will be void. Any implied warranties, obligations, or liabilities, including but not limited to the implied warranty of merchantability and fitness for a particular purpose, shall be limited in duration to the 12-Month duration of this written, limited warranty policy. (Some states do not allow limitations on how long an implied warranty lasts, so the above limitations may not apply to you.) In no event shall Schok be liable for any special, incidental, or consequential damages for breach of this or any other warranty, express or implied, whatsoever. (Some states do not allow the exclusion or limitation of special, incidental, or consequential damages, so the above limitation may not apply to you.) This warranty gives you specific legal rights, and you may also have other rights, which vary from state to state. For more information please visit our webpage www.schokgear.com. ©2021 Schok LLC. All rights reserved.

STEP THREE - HOW TO INSERT THE SIM & SD CARDS

- With the phone facing down, insert fingernail into the back cover cutout, gently but firmly lift and remove the back cover. (See step 2)
- Remove the battery by inserting the fingernail at the bottom of the battery. It is marked "Pull/Jale" and lift the battery out.
- Locate the slot for the Nano SIM card. To unlock, using your fingernail, slide down and carefully lift the SIM card metal lid.
- With the metal lid opened, insert the SIM card, positioning on top of the Sim card space (Angled cut of the SIM card must be facing the top left angled space of the SIM card space).
- Close the metal lid and slide it up to secure the SIM card in place.



- To insert or remove a **Micro SD Memory Card** please repeat number one and number two of this list.
- Locate the slot for the micro SD card (Located at the top right side of the phone, besides the three battery gold connectors)
- Using your fingernail, slide the metal lid to the right and lift it. This will unlock the Micro SD Card tray. Place the Micro SD card in place and lock the metal lid by sliding it to the left.



STEP FOUR - HOW TO TURN ON/OFF YOUR DEVICE



HOW TO NAVIGATE YOUR THE SCHOK CLASSIC

By pressing the 4-way **Navigation Key** you can scroll and select items. Think of it as a compass in which you have UP, DOWN, LEFT and RIGHT. When the item is selected, simply press the OK / Execute Key.



THE LEFT AND RIGHT SOFT KEYS

The soft key is an App driven multi-function key that allows when available to select certain applications or commands at either the left or the right bottom of the display.

SCHOK CLASSIC HOME SCREEN

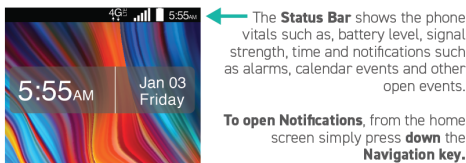

PHONE CALLS

To make a phone call from the **Home Screen**, simply input the number and press the **OK/Execute** key to initiate the call.

To make a phone call from **anywhere in the system** of the Schok Classic simply press the **Back key** until the Home Screen is reached. Input the number and press the **OK/Execute** key to initiate the call.

To make a phone call from the **contact list**. Scroll down the list using the **Navigation key**. Find the contact and press the **Call button**.



TO ANSWER, ACCEPT OR REJECT PHONE CALLS

If the phone is **closed** and begins to ring, the caller ID will tell you who is calling. Simply **flip (open) the phone** and automatically the call will be answered.

If the phone is **opened** and begins to ring, the caller ID will tell you who is calling. press the **Call/Send Key** to answer the call.

To **End or Reject** a phone call, simply press the **END key**.

RECENT PHONE CALLS

The Schok Classic has the ability to automatically create a recent phone list of calls either accepted, missed or dialed. This list is constantly being updated by the new phone calls, deleting the oldest entries.

From the home menu, press the **Call/Send Key** and use the **Navigation key** to scroll left or right to display the records by call type: **Missed calls, Received calls, Dialed Calls, All Calls.**

All calls displays the date, time and the phone number. If the phone number is already added to the address book (Contact) it will include different icons to indicate the type of number.

If there is the need to get more information from a specific recent phone, choose from the following options:

- Press **Left Soft key** to send a message.
- Press **OK/Execute key** to view more call information.
- Press **Right Soft key** to open the options page, showing:
 - Add to contacts:** Save the caller's number as new contact
 - Delete:** Delete the phone record.
 - Delete multiple:** Select the records you want to delete.
 - Lock:** Block or unblock calls from the marked phone number
 - Add to call rejection:** Save the number to a call rejection list

ADDITIONAL PHONE FEATURES

Sound off: Silence the phone when needed. From the Home Screen do the following:

- Press and hold the Volume down key for **vibration mode only**.
- Press the Volume down key one more time for **Alarms only**.
- Press the Volume down key one more time for **All sounds off**. To return to normal please press and hold Volume up until desired volume is reached.

Switching between current phone calls: If you are on a phone call and you receive another phone call the Schok classic will beep that you have another person calling you. The caller ID will work during the call and let you know who is calling.

If you want to **put the current call on hold** and answer the new phone call, simply **Press the Call/Send key**.



If you want to **return to the first phone call**, press the **Call/Send key** again.

Three way call: To do a three-way phone call, while on the first call, press the **Right Soft Key (Options)**, select **New Call** and dial the phone number of the second party.

When the second party answers the phone, press the **Right Soft Key (Options)**, then press the **2 Key** to merge the call.

Block Internet and Data access: Completely block the internet and data access. Go to **settings**, Scroll down, select **Internet and Data control lock**. Click **OK**.

The default password is 0000. It will open a sub-menu with three options. **WiFi:** With the option off or on (By default is ON, means WiFi is ON) **Data:** With the option off or on (By default is ON, means Data is ON) **Change pass-code:** (to change the 0000 password to any other number)

NOTE: If the new password is lost, the phone has to be reset and all information will be lost.

SCHOK

www.schokgear.com

HOW TO CAPTURE SCREENSHOTS

At the same time, press and hold the **Volume down key** and the **Power ON/OFF End Key** for two seconds to capture the current screen.

From the Home Screen click **OK/Execute** to open the installed applications and click **OK/Execute** on **Media Center**.

Scroll down to **"File Manager"** and click **OK/Execute**. Click **OK/Execute** either on Phone or SD card and scroll down to Pictures.

Click **OK/Execute** on the folder named Screenshots.

ADDRESS BOOK (CONTACTS)

The Schok Classic has the ability to save contact information in its memory. To do this, follow the next steps:

1. From the Home Screen, press the **Left soft key** to open the Contacts app.



Left Soft Key

2. Press the **Right soft key** (Options)

3. Press the **OK key** or the number **1** to add a New contact.

4. Using the **Keypad** add the name of the contact.

5. Using the **Navigation key**, press down to the phone number field and enter the phone number.

6. Using the **Navigation key**, press down or up to enter information to other address book fields.

7. Press the **OK key** to save the entry

Emergency contacts:

You can add up to three (3) emergency entries that are already in your address book. To add them, follow these steps:

1. Navigate to contacts (From the Home Screen, press **Contacts**)

2. Navigate to ICE (In case your emergency) and press the **OK key**

3. Choose the ICE entry that you want to use. Then press the **OK key**.

4. Navigate to the desired contact and press the **OK key**.

MESSAGES

The Schok Classic has a built-in message app which allows to send messages. Depending of the type of message you can attach either pictures, sounds, business cards, voice recordings and even videos.

1. Navigate to the Home Screen pressing the **OK key**. Then, press the **Right soft key** to open Message.



Right Soft Key

2. Navigate to Options by pressing the **Right soft key** (Options)

3. Using the **Navigation key** select **New message**

4. Click the **OK key** on **New message**.

5. Select **To:** by pressing the **OK Key**.

6. Using the **Navigation key** scroll down or up to choose the contact that you want to send the message to, press the **OK key** to select it.

7. Click the **Left Soft Key (Done)**

8. Using the **Navigation key** scroll down to **"Input Text"**

9. Using the **Keypad**, write your message. Click the **OK key** to send when done.

To view conversation threads, simply use the **Navigation key** to select a conversation, click the **OK key** to view it.

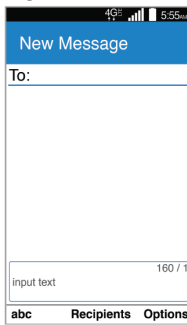

BROWSE THE INTERNET

The Schok classic has a built-in internet browser that can do the majority of things that you can expect from a smartphone browser. To use it its extremely simple.

From the Home Screen, press the **OK/Execute key** and using the **Navigation key** scroll to the application **"Browser"**

Click the **OK/Execute key** on the **Browser app**. (Wait 5 seconds)

Using the **Navigation key** move the black arrow to whatever you want to select, click the **OK key** to execute the command.

If what you want is to go to a specific web address, navigate the black arrow to the "Search or type URL" at the top of the browser.

Immediately after, using the keypad, write the desired webpage to visit.

Tips for correct use of keyboard and special characters:

The **@** symbol and **"** can be located by long pressing the **"#"** symbol on the keypad.

To insert a space press the **"0"** key.

To enter and uppercase character, press the **"*"** (Star) key.

To erase any text or number simply press the **Back key**.

After writing the full web address, for example: "www.schokgear.com" press the **OK Key** to execute the command.

Tabs. Press the **Left Soft Key (Tabs)** to view your open **"Tabs."**

History. The phone has the ability to reload the previously visited web pages. Press the **Right Soft Key (Options)** and scroll to the desired web page.

Bookmark. Press the **Right Soft Key (Options)**, scroll down to **"Bookmark"** Scroll to the desired webpage and click the **OK Key** to execute.

Top. This is a very important feature. If you are browsing a web page and you want to get to the top of the site, press the **Right Soft Key (Options)** and scroll down to **"Top"**, press the **OK Key** to execute.

Fast Scrolling. Press and hold the **Navigation Key** to quickly move the black arrow up and down on the web page.

Tip: By pressing and holding the **OK Key** on a web page, you can use the scroll page function to scroll the webpage.

MULTI-FUNCTION KEY (SHORT PRESS)

Something completely unique about the Schok Classic is the ability to use one key for different things. We call this, the **Schok Multi-Function Key**.

By default, if you do a **short press click** to the **multi-function key** it will open up the Camera App.



However, if you want the Multi-Function key to open a different app, you can easily change this by following these steps:

From the Home Screen press the **OK Key** and then using the **Navigation key** scroll to **Tools & Settings**.

Within **Tools & Settings** scroll down to **Settings** and click the **OK Key**.

In **Settings** scroll down to **Multi-Function Key** and click the **OK Key**.

In the **Multi-Function key** menu there is going to be a list of all the Apps that you can use with this button.

By default the Camera App will say **"On"** and the rest of the Apps will say **"OFF"**.

For example, to change the Multi-function key from the Camera App, to the Calculator App, simply scroll down the list of Apps and highlight the Calculator App, click the **OK Key**. This will turn **"ON"** Calculator and Turns **"OFF"** the Camera app from the Multi-Function Key.

Now, by pressing the **Multi-Function key** the system will open the Calculator App instead of the Camera App.

NOTE: The Camera App as well as all other Apps are always available in the Menu List. From the Home Screen, click the **OK Key** to enter the Menu List, then Scroll to Camera and click the **OK Key**.

OK KEY (LONG PRESS)

Inside any App, by pressing the Long pressing the **OK key** for more than **one second**, it will bring a virtual Mouse that can be controlled by the **Navigation**, and its used to select objects that were created for touch panel devices. To go back to normal, Long press the **OK Key**. This will disable the mouse.

(This function will be ready by free firmware update around March 2020)

CAMERA

1. From the Home Screen, click the **Schok multi-function key**. It will open the Camera app.



2. If your **Multi-Function key** is configured by other App. Please go to **MENU** and scroll to the **Camera App**. Click the **OK key**.

Taking a Picture: To take a photo, point the lens towards the object and click the **OK key**. Your picture will be saved automatically to the **Gallery App**. Click the **Left Soft Key** to open the **Gallery App**.

Zoom In & Out: When pointing the lens towards the object, click the **Left or Right Navigation key** to Zoom in and Zoom out.

TIP: By clicking the **Right Soft Key (Options)** you can access a menu to adjust your camera such as; Auto Review, Self-Timer, Size, Shutter sound and Storage (Storage option is only available if you have a memory card installed).

To take a SELFIE: Open **Camera App**, close phone lid, use secondary display as viewfinder, **click Volume Down key** to take the picture.

Gallery: Shows all the pictures taken and stored in your Schok Classic.

1. From the Home Screen, press the **OK Key** to open the Menu.

2. Using the **Navigation Key**, scroll to **Gallery** and click the **OK Key**.

3. Using the **Navigation Key**, choose the picture that you want to open and click the **OK Key**.

4. Pressing the **Right Soft Key (Options)** you can access a menu to Crop, Delete, Details, Send or Set as Wallpaper or Contact photo.

5. Pressing the **Left Soft Key (Guide)** will open a pop-up window to access, Full Screen view, Rotate (left), Rotate (right) and Zoom in and out. In order work on a pop-up window please use the numbers that appear on each option.

SCHOK CLASSIC DETAILED SPECS

Model number:	SC3218
Operating system:	Android™ 8 (Go edition)
Display Size & Resolution:	3.2" 480 x 800 (WVGA)
Secondary Display:	2" 176 x 220
Processor:	Qualcomm® MSM8909 32Bit
Processor speed and Number of core:	1.1GHz Quad-Core
Graphic processing unit (GPU):	Adreno A304 @ 456MHz
Memory (RAM):	1 GB DDR 3
System and User Memory:	8 GB
SD Card Slot max capacity:	32 GB
Sim card slots and SIM size:	1 Nano SIM card
Rear Camera (primary):	8MP with Autofocus and Flash
Front Camera:	Rear Camera with viewfinder
Rear camera video recording:	720P @ 30 FPS
Battery type:	Lithium ION rechargeable
Battery capacity:	3.8V 1,650 mAh / 6.27Wh
Battery limited voltage:	4.35V
Battery standard:	GB/T 31241-2014/1 CP5/46/58
Wi-Fi and band:	802.11/a/b/g/n. 2.4GHz
GPS:	GPS & AGPS
Bluetooth:	4.2 with BR/EDR + BLE
USB port:	Type-C™ connector
G-Sensor:	Yes
Phone communication standards:	4GLTE/LvLTE/ViLTE
Phone bands 2G:	2G: GSM 850/900/1800/1900
Phone bands 3G:	UMTS Band 2/4/5
Phone CDMA bands:	BC0 / BC1 / BC10
Phone bands 4G:	2/4/5/12/13/17/25/26
Phone bands 4G:	28(A&B)/30/41/66/71
Hearing Aid Compatibility:	M4 / T4
Dimensions:	4.52 x 2.28 x 0.74 inches
Phone weight with Battery:	4.76oz
Phone weight without Battery:	3.70oz
Structure outside & Inside:	Plastic
Phone electric input:	5.0V ± 1.0A
USB Wall charger input:	100-240V ~ 50/60Hz 0.2A
USB Wall charger output:	5.0V ± 1.0A

GLOSSARY:

Back / Clear Key: One Click returns to the previous menu, keep clicking, will take you to the Home Screen.

Back Cover: Protects internals, access battery, SIM and Memory card.

Battery: (Hardware) Give power to device.

Call / Send Key: Answer/make phone calls. Long press access call history.

Camera: (Hardware) Location of actual Camera.

Charger Port: (Hardware) Location of charging/sync port.

Earpiece: (Hardware) Allows the other caller to be heard.

Headset Jack: (Hardware) Allows to connect a 3.5mm hands-free headset.

Keypad Lock: Long pressing keypad will be locked or unlocked.

Main Display: Shows notifications, features, messages and active functions.

Microphone: (Hardware) Transmits voice to the other party during a call.

Multi-Function Key: Short Click turns on the camera app. Can be changed to any other app installed in the device. Long pressing it turns on the virtual mouse.

Navigation Key: Can scroll through all the menus and apps of the device.

Numeric Keypad: Used to enter numbers, alphabetical text and shortcuts.

OK / Execute Key: Used to select options, select apps and execute actions.

Power ON/Off/ End Key: Turns device ON/Off, ends calls, exits menus.

SD Card: (Hardware) Slot for a micro SD Card. 64GB maximum.

Secondary Display: (Hardware) Displays messages, notifications and time.

SIM card: (Hardware) Slot for a Nano SIM card.

Soft Keys: allows when available to select certain applications or commands.

Speaker: (Hardware) Allows to hear the emitted sounds from your device.

Volume Keys: (Hardware) Allows to adjust the volume up or down.